



Product Category

13D-A-SS-R

Product Line

Cast Iron & Bronze Flanged Check Valves (10D, 11D, 12D, 13D, 20D, 21D)

Part Description

CLASS 300 Flange Style Silent Check Valve with Bronze Body and Stainless Steel Trim

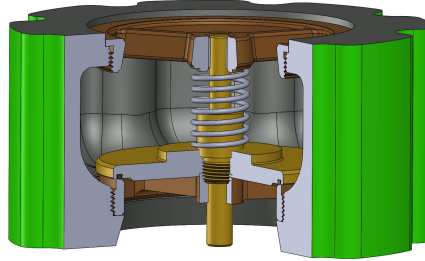

DIMENSIONS

Face to Face	2.63
Dia. of Bolt Circle	5.00
Dia. of Flange	6.50
No. of Studs	8
Dia. of Studs	0.63
Length of Studs	7.00
Weight (lbs.)	9

GENERAL

Pressure Rating	300 PSI
Temperature Range	-30°F to 250°F (-34°C to 121°C)
Standard Soft Goods	Buna-N O-Rings
Cartridge Type	Check
Connection Type	ANSI B16.5 Flange
Connection Size	2"
Body Material	Valve Bronze, ASTM B61, UNS C92200



OPTIONS

Port & Vent Options

[-DP] Drain Plug Above Seat (3/8" NPT)

Optional Soft Goods

Viton® O-Rings, EPDM O-Rings